

# COMP SPL Show

ST 25

100W



## Technical Specifications

Component	High Efficiency Compression Driver	
Size	mm (in.)	25 (1)
Power handling		
W peak		100
W continuous	Hi-pass filtered @ 5 kHz - 12 dB Oct.	
Impedance	$\Omega$	4
Frequency response	Hz	3k ÷ 20k
Sensitivity	dB/SPL	107
Voice coil $\varnothing$	mm (in.)	25 (1)
Magnet	Neodymium	
Dome/Cone	Aluminium	
Weight of one component	kg (lb)	0,52 (1.1)

1. High magnetic permeability plates provide constant, even flux.
2. Neodymium magnet, for top SPL performance.
3. CCAR (Copper Clad Aluminium Ribbon) voice coil; for unheard-of thermal and mechanical capability.
4. Extralight aluminium membrane.
5. Anodized aluminium body; for maximum damping and vibration rejection.
6. High current, screw terminals.
7. High efficiency compression loading horn.

## Electro-Acoustic Parameters

D	mm	25
Xmax	mm	-
Re	$\Omega$	2,9
Fs	Hz	3400
Le	mH @ 1 kHz	-
Le	mH @ 10 kHz	-
Vas	l	-
Mms	g	-
Cms	mm/N	-
BL	T•m	-
Qts	-	-
Qes	-	-
Qms	-	-
Spl	dB	107

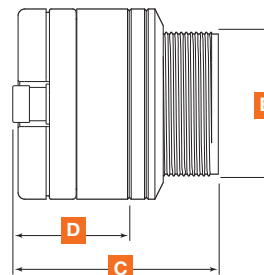
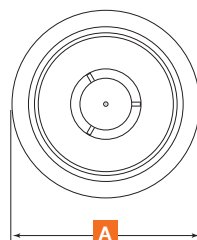
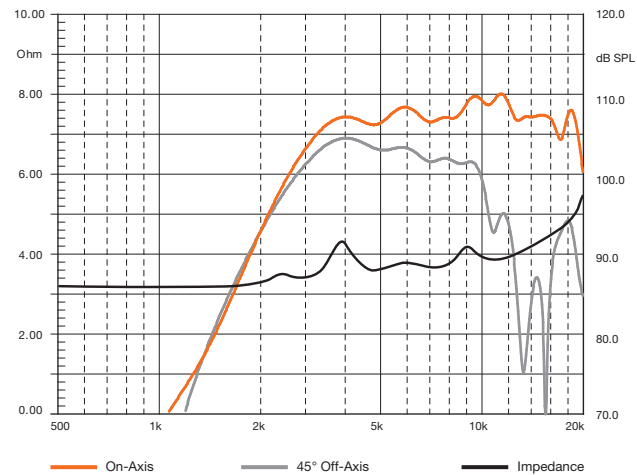

A	57,5 mm (2.3 in.)
B	43,5 mm (1.7 in.)
C	63 mm (2.5 in.)
D	37 mm (1.4 in.)